

- NOTES:
1. PHARAD P/N 100554
  2. TRACEABILITY: PHARAD S/N
  3. PART MARKING: PHARAD LABEL 101108-003
  4. FREQUENCY OF OPERATION: 225 - 2500 MHz
  5. WEIGHT: 3 OZ

REVISIONS				
ZONE	REV.	DESCRIPTION	DATE	APPROVED
N/A	A	ENGINEERING PROTOTYPE	10/19/2010	JDM
N/A	A-01	REVISED POUCH LABEL TO INCLUDE S/N	2/21/2011	JDM

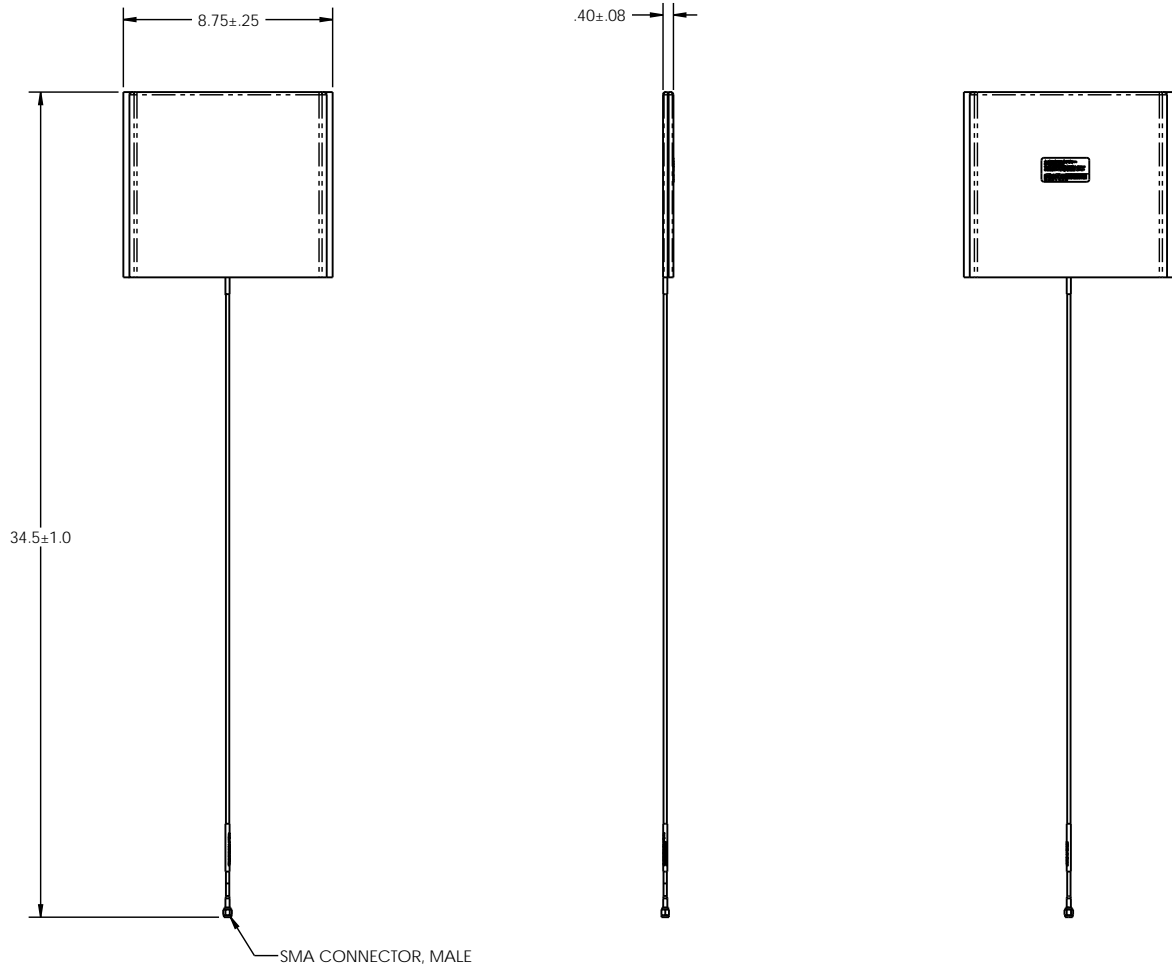

**PROPRIETARY AND CONFIDENTIAL**  
 THE INFORMATION CONTAINED IN THIS DRAWING IS THE SOLE PROPERTY OF PHARAD, LLC. ANY REPRODUCTION IN PART OR AS A WHOLE WITHOUT THE WRITTEN PERMISSION OF PHARAD, LLC IS PROHIBITED.

UNLESS OTHERWISE SPECIFIED:			DRAWN: JDM		NAME: JDM		DATE: 10/19/2010		PHARAD, LLC 197 CROMWELL PARK DRIVE, SUITE V GLEN BURNIE, MD 21061	
DIMENSIONS ARE IN INCHES			CHECKED:		ENG APPR:		MFG APPR:		TITLE: <b>ASSEMBLY, WEARABLE ANTENNA, 225-2500 MHz</b>	
TOLERANCES:			TWO PLACE DECIMAL: ±.010		THREE PLACE DECIMAL: ±.005		ANGULAR: ±1°		SIZE: DWG. NO. <b>C</b> BW-225-2500	
MATERIAL:			SEE NOTES		REVISION:		DO NOT SCALE DRAWING		REV: <b>A-01</b>	
COMMENTS:			SEE NOTES		SCALE: 1:4		SHEET 1 OF 1			